

UPON ENTRY: MASK ON
 Your Athlete will meet their assigned Ambassador here

It is the Ambassadors job is to make sure your Athlete is in the right place at the right time. Please help them by adhering to their instructions and being on time.

**If, for medical or physical reasons you need to accompany your Athlete to the warmup area, please inform the Ambassador. Accommodations will be made where possible, if it is safe to do so.*

CHAPERONE SEATING
 You may be directed to an assigned seating area. Please do not keep changing seats or consume food here. This is for your own health and safety; we have sanitation rotations in place.

After your Athlete has skated, they will remove their skates, gather their belongings, and exit through to the concourse where they will meet you either in the stands or concourse area.

Results will be posted online (scan the QR code on the back of your Athletes credential). You may exit the facility and return once results are posted, or you may wait in the Awards holding area up in the stands.

ARENA EVENT FLOW: SPECTATORS & CHAPERONES

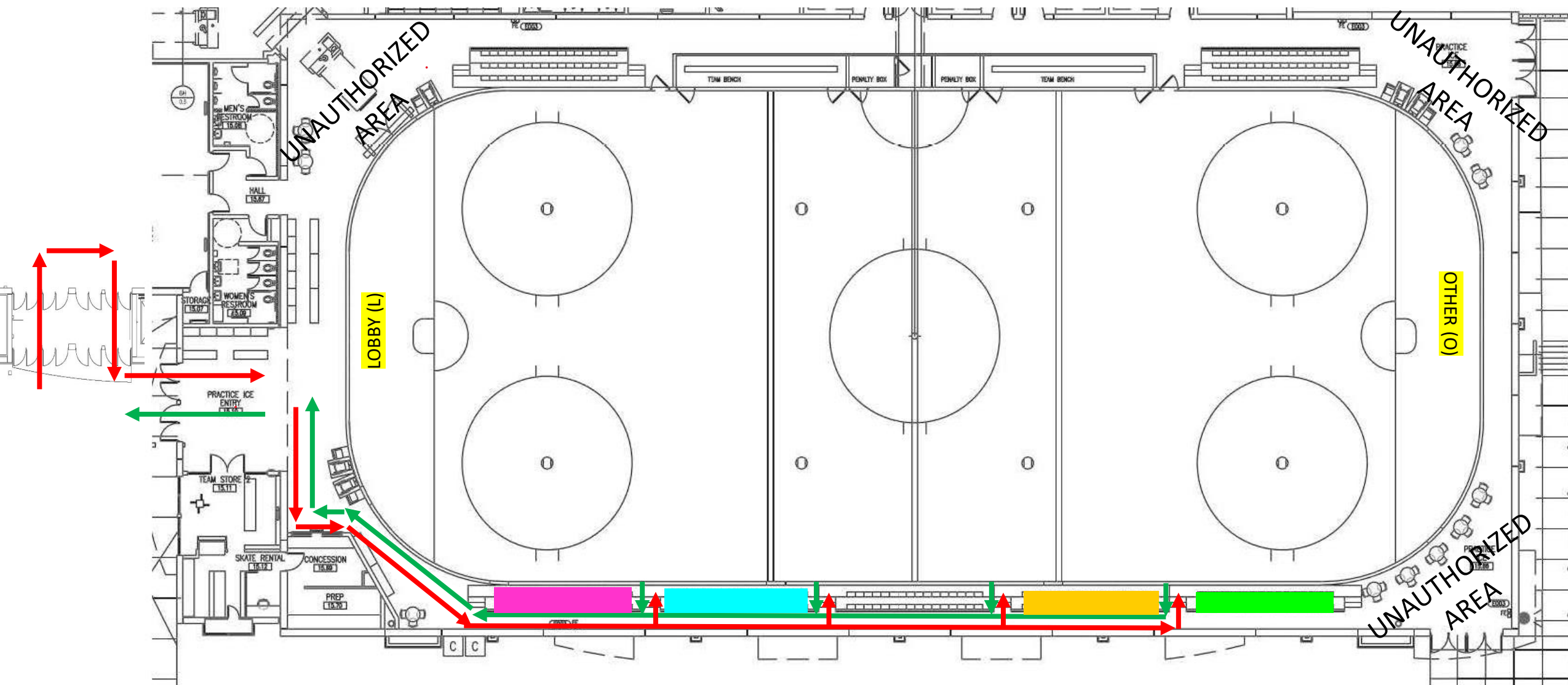

COMMUNITY EVENT FLOW: SPECTATORS & CHAPERONES